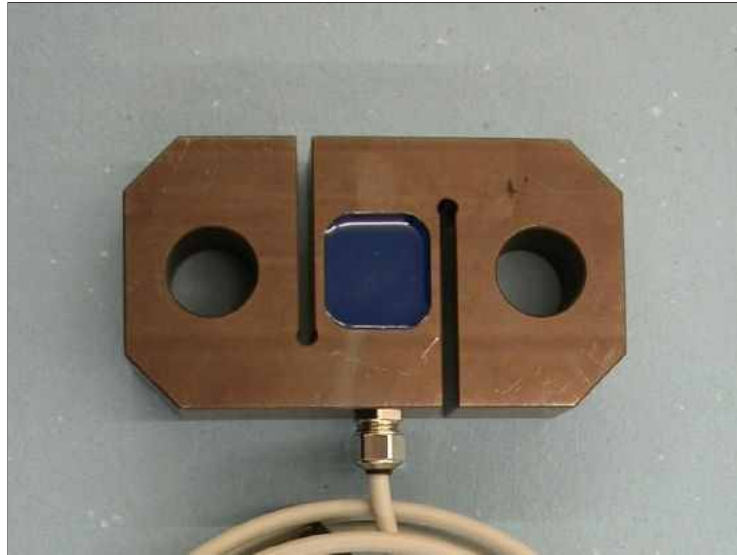

Plate Load Cell KWZ-60-10/20-1.XX



description

The plate load cell works according to the strength measuring principle on a transverse basis to the longitudinal axis.

Attractions can be included at lifts, cranes, rope tensions to masts of radio transmitting installations, chimneys, cooling towers, gondolas, assembly platforms, tunnel stiffenings etc.

Two anchor clevises (3.250 kg) appropriate a simply putting in to load hooks, trolleys, oval eyes, for chain conduits, raising belts etc.

It is executed as a s-shaped beam with a measuring cell.

The strain gauge bridges measure the deformation caused by clipping strengths on the beam in the measuring cell. Executions with strap output or amplifier with a measuring signal of 1 - 9 mA or 4 - 20 mA are possible for it.

By application of an amplifier the nominal output current can be produced in the unloaded state by add-ons of the calibrating checking signal (software calibration). A check of the plate load cell with the amplifier and the following measuring facilities is possible with that.

The KWZ-60 is planned according to execution for the direct connection with an amplifier or a control.

specification

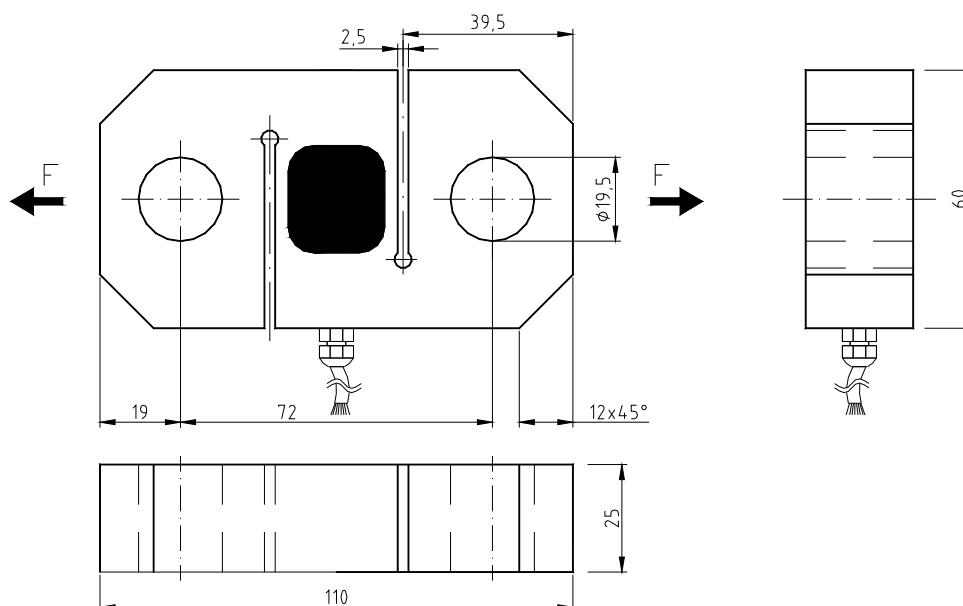

mechanical execution

weight
mounting
material
environmental protection

approx. 4 kg
clevis
steel
IP 67

KWZ

60-10

60-20

nominal force
max. use force
rupture force

10 kN	20 kN
200 % of the nominal force	200 % of the nominal force
400 % of the nominal force	400 % of the nominal force

electrical execution

operating voltage
current consumption
output / measuring signal
calibration in
calibration tolerance
nonlinearity
hysteresis
temperature coeff.
zp.
rec.
operating condition

when strap with 350 Ω : max. 12 V AC / DC
when amplifier: 9 - 30 V DC
max. 35 mA / 40 mA (according to execution)
350 Ω / 1 - 9 mA / 4 - 20 mA (options)
N / kg
< 0,50 % of the final value*
< 0,25 % of the final value*
< 0,15 % of the final value*
 $\leq 0,04$ % of the final value / K
 $\leq 0,04$ % of the set point / K
-25 °C to +80 °C**

connection

cable type
electrical connections

1,5 m LiYCY 4 x 0,14 mm² (example)
when
brown
green
yellow
white
blue
strap / amplifier
strap voltage U_s+ / operating voltage
strap voltage U_s- / GND (ground)
strap signal U_o+ / measuring signal output
strap signal U_o- / calibration signal (low activ)***
protection

* These details are depending on the fit, the resistance moment and the installation length. They are reached with favorable values.

** in case the laid cable is fixed

*** If the calibration signal is not used, then this cable should be clamped together with the brown wire at the operating voltage.